

## Rossi Model 92-SRC Carbine

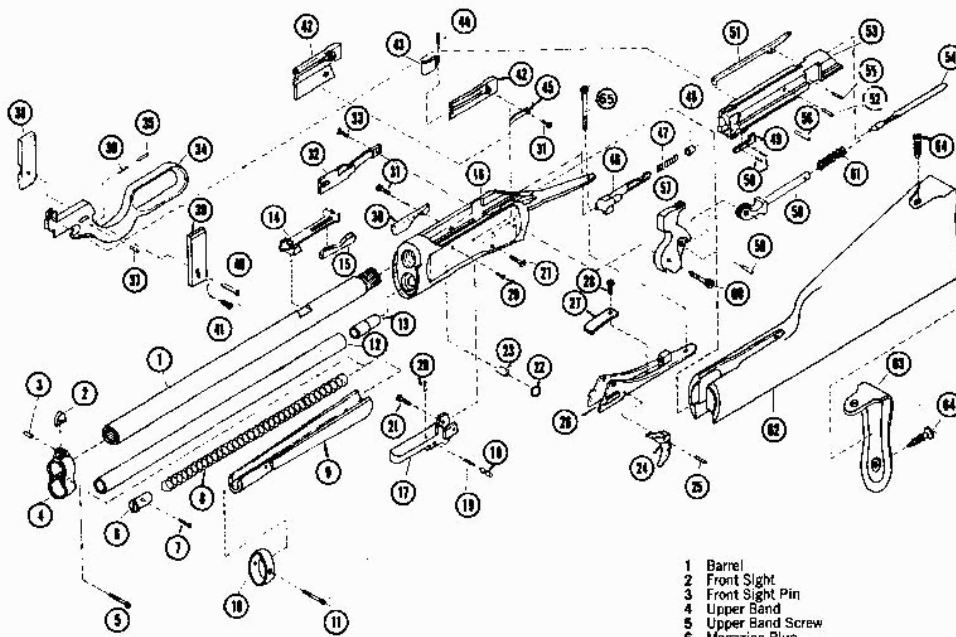

- |    |   |
|----|---|
| 1  | Barrel                                  |
| 2  | Front Sight                             |
| 3  | Front Sight Pin                         |
| 4  | Upper Band                              |
| 5  | Upper Band Screw                        |
| 6  | Magazine Plug                           |
| 7  | Magazine Plug Screw                     |
| 8  | Magazine Spring                         |
| 9  | Fore-end                                |
| 10 | Lower Band                              |
| 11 | Lower Band Screw                        |
| 12 | Magazine Tube                           |
| 13 | Magazine Follower                       |
| 14 | Rear Sight Assembly                     |
| 15 | Elevator                                |
| 16 | Receiver                                |
| 17 | Carrier                                 |
| 18 | Carrier Stop                            |
| 19 | Carrier Stop Spring                     |
| 20 | Carrier Stop Pin                        |
| 21 | Carrier Screw                           |
| 22 | Saddle Ring                             |
| 23 | Saddle Ring Support                     |
| 24 | Trigger                                 |
| 25 | Trigger Pin                             |
| 26 | Lower Tang                              |
| 27 | Trigger Spring                          |
| 28 | Trigger Spring Screw                    |
| 29 | Lever & Breech Bolt Pin Hole Plug Screw |
| 30 | Cartridge Guide, Right                  |
| 31 | Cartridge Guide Screw                   |
| 32 | Spring Cover                            |
| 33 | Spring Cover Screw                      |
| 34 | Finger Lever                            |
| 35 | Friction Stud                           |
| 36 | Friction Stud Spring                    |
| 37 | Friction Stud Stop Pin                  |
| 38 | Locking Bolt, Right                     |
| 39 | Locking Bolt, Left                      |
| 40 | Locking Bolt Pin                        |
| 41 | Locking Bolt Pin Stop Screw             |
| 42 | Cartridge Guide, Left                   |
| 43 | Cartridge Stop                          |
| 44 | Cartridge Stop Joint Pin                |
| 45 | Cartridge Stop Spring                   |
| 46 | Ejector                                 |
| 47 | Ejector Spring                          |
| 48 | Ejector Collar                          |
| 49 | Ejector Spring Stop                     |
| 50 | Ejector Spring Stop Pin                 |
| 51 | Extractor                               |
| 52 | Extractor Pin                           |
| 53 | Breech Bolt                             |
| 54 | Firing Pin                              |
| 55 | Firing Pin Stop Pin                     |
| 56 | Lever & Breech Bolt Pin                 |
| 57 | Hammer                                  |
| 58 | Mainspring Rod                          |
| 59 | Mainspring Rod Pin                      |
| 60 | Hammer Screw                            |
| 61 | Mainspring                              |
| 62 | Stock                                   |
| 63 | Buttplate                               |
| 64 | Buttplate Screws (2)                    |
| 65 | Upper Tang Screw                        |